

Landscapes of Worcestershire

Landscape Type Information Sheet

Estate Farmlands

Landscape Type Description

An ordered agricultural landscape characterised by a sub-regular pattern of medium to large sized fields, small geometric plantations and groups of ornamental trees associated with large country houses. Settlement is largely restricted to discrete clusters of dwellings and occasional small estate villages.



Key Characteristics

Primary

- Hedgerow boundaries to fields
- Planned woodland character

Secondary

- Mixed farming land use
- Discrete settlement clusters and small estate villages
- Medium-framed views

Tertiary

- Semi-regular pattern of medium-to-large fields
- Small geometric plantations and belts of trees
- Large country houses set in mature grounds
- Rolling lowland with occasional steep-sided hills and escarpments

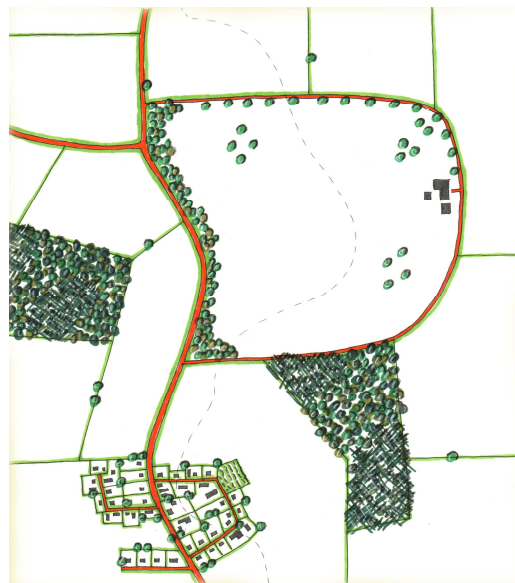

This is a landscape similar in many ways to the Sandstone Estatelands, depending upon tree cover and field pattern to provide its structure and scale.

The character, however, is based upon the small plantation woodlands together with the tree features associated with estates and parklands, but relating to a tree cover and field pattern that lacks the strong geometric framework of the Estate Sandlands.

Landscape Type Information Sheet

Enclosed Commons

This is a landscape of increasingly dominant arable land uses where the function of hedgerows can accordingly become gradually redundant. Hedgerow loss and deterioration is already apparent and it can only be assumed that this will accelerate. Some localities such as Croome and Pirton contain the relics of extensive parkland plantings, the remnants of which are now often located amidst arable land. Estate villages with distinctive architectural styles and detailing are often associated with such areas but face dilution of their distinctive character by modification and new development. These are landscapes that have restricted opportunities for wildlife.

These are areas that can accommodate considerable new woodland planting which would be of benefit in strengthening the overall landscape structure. The restoration of tree cover associated with parkland and ornamental grounds together with improving the tree cover along watercourses should also be encouraged. The conservation of the hedgerow pattern is desirable but priority should be given initially to the primary hedgerow framework. In order to improve opportunities for wildlife, the development of good field margins is of particular relevance in these landscapes.

The overall landscape strategy for the Estate Farmlands would, therefore be to restore and enhance the distinctive estate characteristics of this farmed landscape, - seeking primarily to enhance the landscape with further woodland planting, whilst seeking to restore the parkland character and primary hedgerow patterns.

Landscape Guidelines

- Enhance tree cover through further planting of small scale plantations and tree belts
- Conserve the pattern of hedged fields, with priority given to primary hedgelines
- Conserve and restore parkland and the tree cover associated with large ornamental grounds
- Conserve and enhance tree cover along water courses
- Promote the development of wide field margins for wildlife benefit
- Conserve the integrity of estate villages

For more information visit our website www.worcestershire.gov.uk/lca or contact the Worcestershire County Council Environmental Policy Team on 01905 766038