



DEFINITIVE MAP MODIFICATION ORDER APPLICATION PRIORITISATION

Application	Proposed deletion and amendments in the parish of Bewdley
File Ref	M-2065
Applicant	Clive Prince
Date Submitted	20 th August 2024

Application Prioritisation Criteria	Score
Conflict Resolution	2
Development	1
Effective use of Resources	1
Level of Support	1
The Wider Public Rights of Way Network and ROWIP Objectives	1

Total	6
--------------	----------

Details of how these have been prioritised can be found in the DMMO Application Prioritisation Standard Operational Procedure

Summary of Information provided for Definitive Map Modification Order

The information below provides a summary for accessibility purposes of the scanned original application form documents attached.

Application Reference:

Applicant Name

Dr Clive Prince

Applicant Address

The Stables, Ribbesford, Bewdley, DY12 2TW

The above hereby apply for an order under section 53(2) of the Wildlife and Countryside Act 1981 modifying the definitive map and statement for the area by:

Deleting footpath 569 from where it crosses 589 to where it joins 599.

Diverting footpath 600 from where it crosses the stile where the track turns into Park Farm Courtyard which also affects 589 and 599 to the western end of 600 by providing that the path of 600 follows the link it has followed for 65+ years which is the grey dashed marking, the footpath as shown on WCC 'report a public right of way issue' map.

And shown on the map accompanying this application.

Dated and signed

20th August 2024.

Confirmation was also submitted that Notice was served by the applicant on the following landowners of this application being made:

 Park Farm, Ribbesford, Bewdley

Scanned application documents



APPLICATION FOR MODIFICATION ORDER [M.O.1] WILDLIFE AND COUNTRYSIDE ACT 1981

TO: MAPPING MANAGER, PUBLIC RIGHTS OF WAY TEAM, WORCESTERSHIRE COUNTY COUNCIL
OF: WORCESTER WOODS COUNTRY PARK, WILDWOOD DRIVE, WORCESTER WR5 2LG

I/We DR CRAVE BENJAMIN PRINCE
of (address) THE STABLES PARKFARM, RIBBESFORD, BENDLEY
(email & tel. no) clive.prince@btinternet.com

hereby apply for an order under Section 53(2) of the Wildlife and Countryside Act 1981 modifying the definitive map and statement for the area by (fill out the appropriate section below):

- i. Deleting footpath / bridleway / restricted byway / byway open to all traffic (No. 59,6(c))
From where it crosses 589(c)
To where it joins 599(c)
- ii. Adding a footpath / bridleway / restricted byway / byway open to all traffic
From.....
To.....
- iii. Upgrading/downgrading footpath / bridleway / restricted byway / byway open to all traffic (No) to the new status of footpath / bridleway / restricted byway / byway open to all traffic.
From.....
To.....
- iv. Varying (adding to) the particulars (the definitive statement) relating to the footpath / bridleway / restricted byway / byway open to all traffic (No 600(c)) which also affects 599(c)
From THE STYLE WHERE THE TRACK TURNS INTO PARK FARM COURT YARD
To THE WESTERN END OF 600(C)

By providing that THE PATH OF 600(C) FOLLOWS THE LINE IT HAS FOLLOWED FOR 65 YEARS WHICH IS THE GREY DASHES MARKING THE FOOT PATH AS SHOWN ON WCC REPORT A PUBLIC RIGHTS OF WAY ISSUE' MAP and shown on a map accompanying this application.

I/We attach a separate list of documentary evidence (including witness statements, maps etc. in support of this application. (YES/ NO

Dated 20th August 2024 Signed.....



worcestershire
countycouncil

CERTIFICATE OF SERVICE OF NOTICE OF
APPLICATION FOR MODIFICATION ORDER
WILDLIFE AND COUNTRYSIDE ACT 1981

TO: MAPPING MANAGER, PUBLIC RIGHTS OF WAY TEAM,
WORCESTERSHIRE COUNTY COUNCIL

OF: WORCESTER WOODS COUNTRY PARK, WILDWOOD DRIVE,
WORCESTER WR5 2LG

I/We CLIVE BENJAMIN PRINCE
of THE STABLES, PARK FARM, RIBBSFORD, BENDLEY DY12 2TW
Email & Tel No. clive.prince@bcinternet.com [REDACTED]

hereby certify that the requirements of paragraph 2 of Schedule 14 of the Wildlife and
Countryside Act 1981 have been complied with, and notice has been duly served on the
following occupiers:

Name Address

[REDACTED] PARK FARM
RIBBSFORD
BENDLEY

Dated 30/01/2025 Signed [REDACTED]

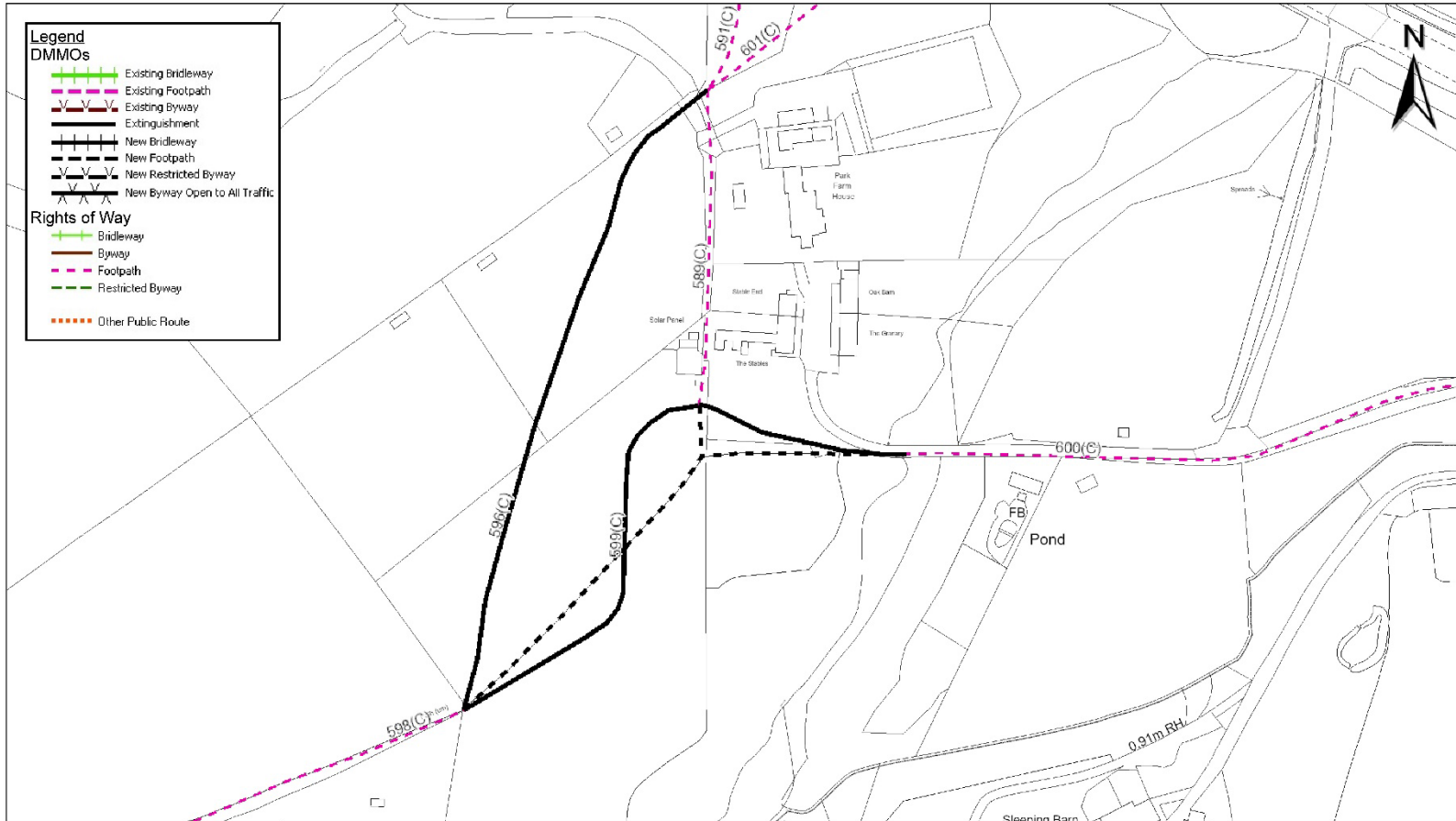

© Crown copyright and database rights 2024
Ordnance Survey AC0000809204.

Indicative Scale: 1:1,800

Date Printed: 17/12/2024

0 20 100 200 metres

M-2065- WILDLIFE AND COUNTRYSIDE ACT 1981
DEFINITIVE MAP MODIFICATION ORDER
PROPOSED DELETION AND AMENDMENTS IN THE PARISH OF BEWDLEY

worcestershire
county council

Worcestershire County Council
County Hall
Spetchley Road
Worcester
WR5 2NP