

NOTICE OF MAKING OF RAIL CROSSING EXTINGUISHMENT ORDER
HIGHWAYS ACT 1980 SECTION 118A AND COUNTRYSIDE AND WILDLIFE ACT 1981
SECTION 53

WORCESTERSHIRE COUNTY COUNCIL

STOPPING UP OF FOOTPATHS

TC-504 (FORMERLY FOOTPATH 1) IN THE PARISH OF TUTNALL AND COBLEY AND
LK-524 (PART) (FORMERLY FOOTPATH 61) IN THE PARISH OF LICKEY
PUBLIC PATH EXTINGUISHMENT AND DEFINITIVE MAP MODIFICATION ORDER 2024

The above order was made on 29 February 2024, under section 118A of the Highways Act 1980 (as amended by the Transport and Works Act 1992) and Section 53 of the Wildlife and Countryside Act 1981. The order will extinguish the public footpaths at Tutnall & Cobley and Lickey and modify the definitive map and statement for Worcestershire accordingly.

LK-524 (formerly No. 61) (Part). The entire width and length of the footpath to be extinguished commences at Ordnance Survey Grid Reference (OSGR) SO 9965 7231 (point A on the order plan) and runs SE for 50 metres (m) to meet footpath TC-504 on the parish boundary with Tutnall & Cobley at OSGR SO 9968 7227 (point B on the order plan).

TC-504 (formerly No. 1). The entire width and length of the footpath to be extinguished commences from footpath LK-524 on the parish boundary with Lickey at OSGR SO 9968 7227 (point B on the order plan). It proceeds in a SE direction for 16 m to a junction with footpaths TC-505 and TC-503 at OSGR SO 9968 7226 (point C on the order plan).

A copy of the order and the order map have been placed and may be seen free of charge at Alvechurch Library, Birmingham Road, Alvechurch, Birmingham, B48 7TA during normal opening hours. Library computer use can be pre booked on 01905822722 or via the following email address: WorcesterLib@worcestershire.gov.uk (copies may be printed at the library; usual charges apply).

The documents can also be viewed online at: [Worcestershire County Council Orders for Public Consultation](#).

Any representations about or objections to the order may be sent in writing to: the **Mapping Manager, Public Rights of Way Mapping Team, The Countryside Centre, Worcester Woods Country Park, Spetchley Road, Worcester, WR5 2LG** or countryside@worcestershire.gov.uk. not later than 19th of April 2023: Please state the grounds on which they are made.

If no such representations or objections are duly made, or if any so made are withdrawn, the County Council may confirm the order as an unopposed order. If the order is sent to the Secretary of State for the Environment, Food and Rural Affairs for confirmation any representations and objections which have not been withdrawn will be sent with the order.

Dated 20th of March 2024

THOMAS POLLOCK
Head of Commercial Law, Legal and Governance

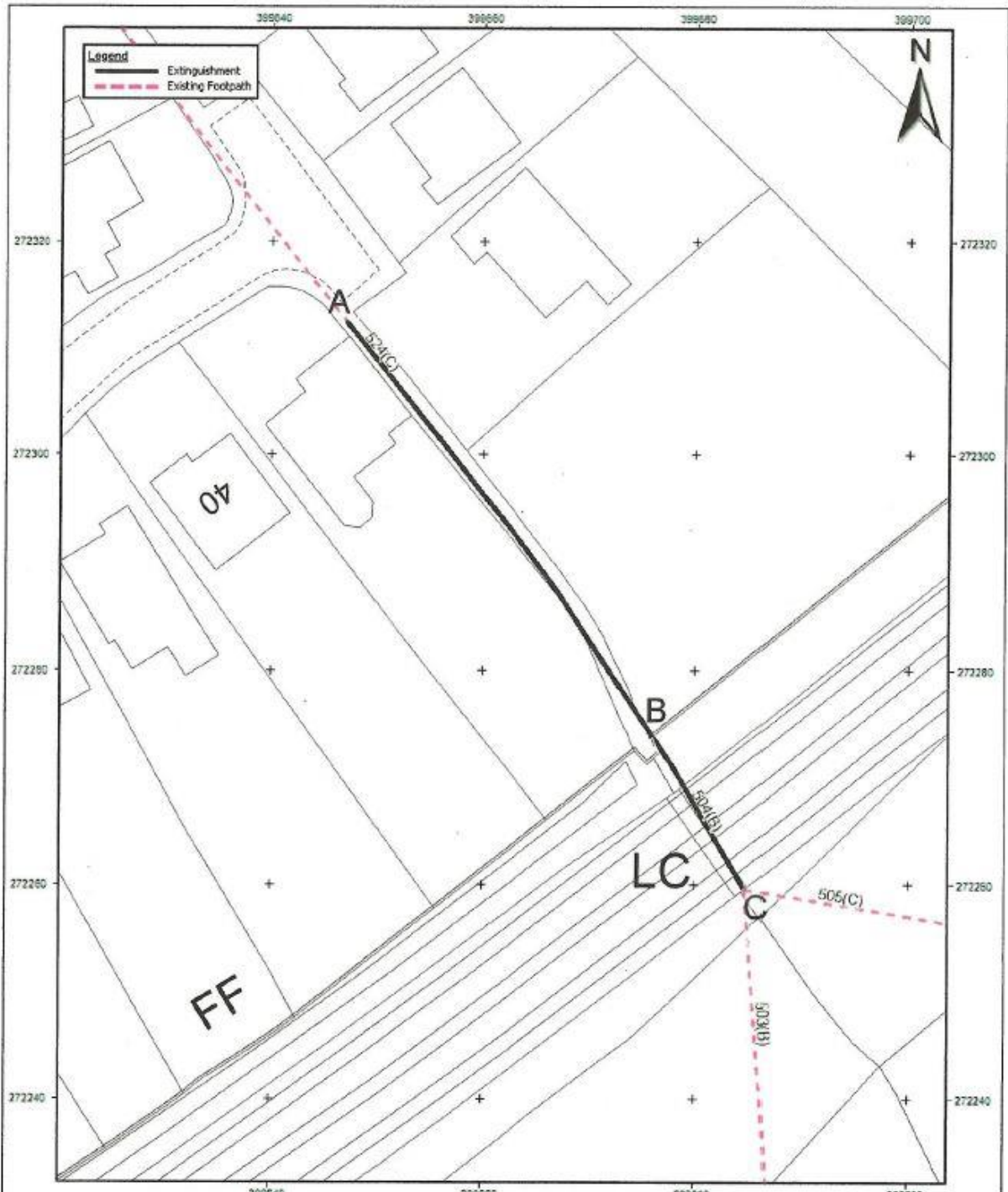

<p>© Crown copyright and database rights 2024 Ordnance Survey AC0000809204.</p>	<p>0 2 10 20 metres</p>	<p>worcestershire county council</p>
<p>Indicative Scale: 1:500</p>	<p>Extinguishment of Footpath LK-542 (Part) and TC-504 - Order Plan</p>	
<p>Date Printed: 6/2/2024</p>	<p>Made under Section 118A of the Highways Act 1980 and Section 53 of the Wildlife and Countryside Act 1981</p>	
<p>Countryside Service Worcester Woods Country Park Wildwood Drive Worcester WR5 2LG</p>		