



## DEFINITIVE MAP MODIFICATION ORDER APPLICATION PRIORITISATION

<b>Application</b>	Addition of a footpath from C2300 Leamington Road to footpath BY-521 Broadway
<b>File Ref</b>	<b>M2036</b>
<b>Applicant</b>	Broadway Parish Council c/o Kevin Beasley, Clerk to the Council  Email: broadway.pariah.council@unicombox.co.uk
<b>Date Submitted</b>	

<b>Application Prioritisation Criteria</b>	<b>Score</b>
Conflict Resolution	3
Development	1
Effective use of Resources	1
Level of Support	3
The Wider Public Rights of Way Network and ROWIP Objectives	1
<b>Total</b>	<b>9</b>

Details of how these have been prioritized can be found in the DMMO Application Prioritisation Standard Operational Procedure

## Summary of Information provided for Definitive Map Modification Order

The information below provides a summary for accessibility purposes of the scanned original application form documents attached.

### Application Reference. M2036

#### Applicant Name

Broadway Parish Council

#### Applicant Address

5 Russell Square, High Street, Broadway, Worcestershire WR12 7AP

The above hereby apply for an order under section 53(2) of the Wildlife and Countryside Act 1981 modifying the definitive map and statement for the area by:

Adding a footpath from Leamington Road to the point it joins footpath number 521

And shown on the map accompanying this application.

#### Dated and signed

18 November 2019

Confirmation was also submitted that Notice was served by the applicant on the following landowners of this application being made.

Spitfire Bespoke Homes Ltd The Gate, International Drive, Solihull B90 4WA  
Arden House, Sheep Street, Chipping Campden, Gloucestershire GL55 6DR

Scanned application documents



NOTICE OF APPLICATION FOR MODIFICATION ORDER  
WILDLIFE AND COUNTRYSIDE ACT 1981

TO: MAPPING MANAGER, PUBLIC RIGHTS OF WAY TEAM, WORCESTERSHIRE  
COUNTY COUNCIL  
OF: WORCESTER WOODS COUNTRY PARK, WILDWOOD DRIVE, WORCESTER  
WR5 2LG

We..... Broadway Parish Council  
of..... 5 Russell Square, High Street, Broadway, Worcestershire. WR12 7AP  
Email address & Tel No. 01386 854813 broadway.pariah.council@unicombox.co.uk

hereby apply for an order under Section 53(2) of the Wildlife and Countryside Act 1981  
modifying the definitive map and statement for the area by:

~~i. Deleting footpath / bridleway / restricted byway / byway open to all traffic (No.....)~~

From.....

To.....

ii. Adding a footpath / bridleway / restricted byway / byway open to all traffic

From Leamington Road (point A)

To.. The point it joins footpath no: 521 (point B) - please see attached map

~~iii. Upgrading/downgrading footpath / bridleway / restricted byway / byway open to all  
traffic (No.....) to the new status of footpath / bridleway / restricted byway /  
byway open to all traffic.~~

From.....

To.....

~~iv. Varying (adding to) the particulars (the definitive statement) relating to the footpath /  
bridleway / restricted byway / byway open to all traffic (No.....)~~

From.....

To.....

By providing that.....

.....

and shown on a map accompanying this application.

We attach have provided a separate list of documentary evidence (including witness  
statements, maps etc. in support of this application. YES/NO

Dated 18<sup>th</sup> November 2019

Signed.....



Broadway Parish Council

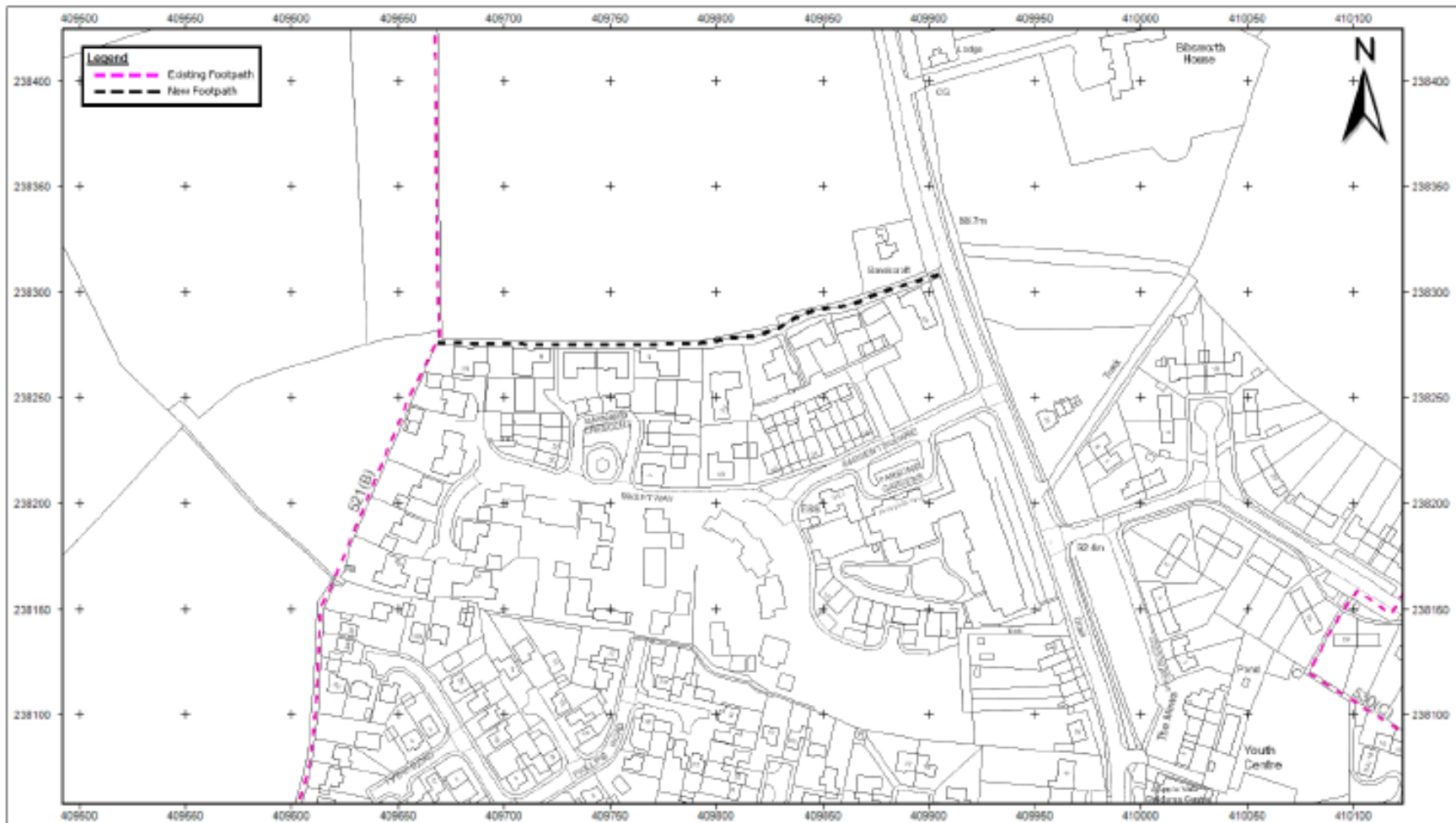

© Crown copyright and  
database rights 2020  
Ordnance Survey 100024230.

Indicative Scale: 1:2,500

Date Printed: 19/2/2020

0 20 100 200 metres

Wildlife & Countryside Act 1981  
Definitive Map Modification Order  
District of Wychavon, Parish of Broadway  
Application to add a footpath to the Definitive Map and Statement from Leamington Road to footpath BY-521, Broadway

 **worcestershire**  
county council

Countryside Service  
Worcester Woods Country Park  
Wildwood Drive  
Worcester  
WR5 2LG