

© Crown copyright and database rights 2020  
Ordnance Survey 100024230.

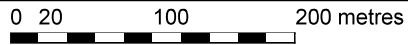

**WCC PLAN 1 - LITTLEWORTH FARM, WORCESTER ROAD, INKBERROW, WORCESTER WR7 4EX**



Worcestershire County Council  
County Hall  
Spetchley Road  
Worcester  
WR5 2NP

Indicative Scale: 1:5,000

Date Printed: 7/5/2020

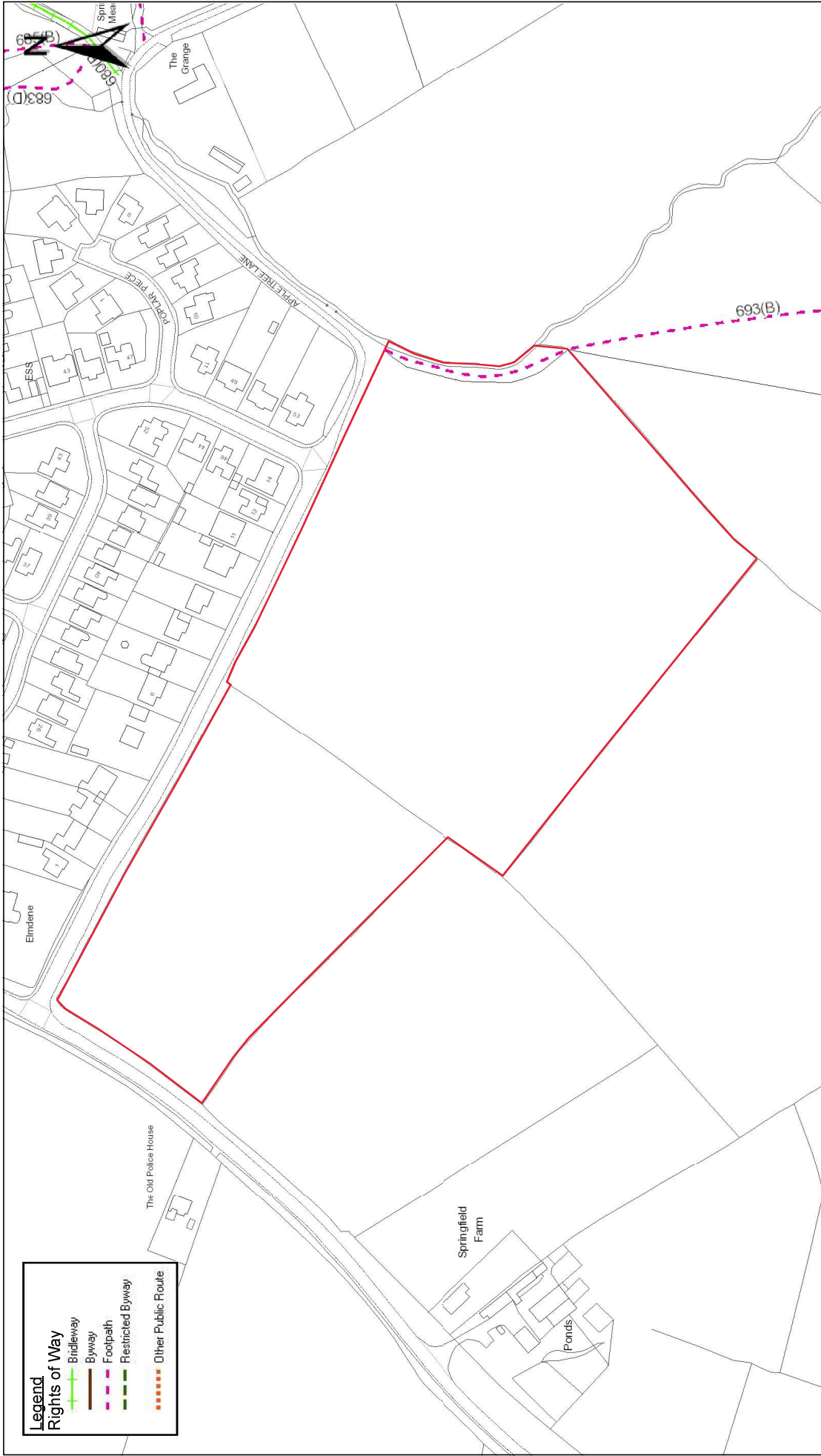

Legend	
Rights of Way	
	Bridleway
	Byway
	Footpath
	Restricted Byway
	Other Public Route



Worcestershire County Council  
 County Hall  
 Spetchley Road  
 Worcester  
 WR5 2NP

WCC PLAN 2 - LAND AT APPLE TREE LANE, INKBERROW, WORCESTER (nearest postcode WR7 4JA)

© Crown copyright and database rights 2020  
 Ordnance Survey 100024230.

Indicative Scale: 1:2,500

Date Printed: 7/5/2020

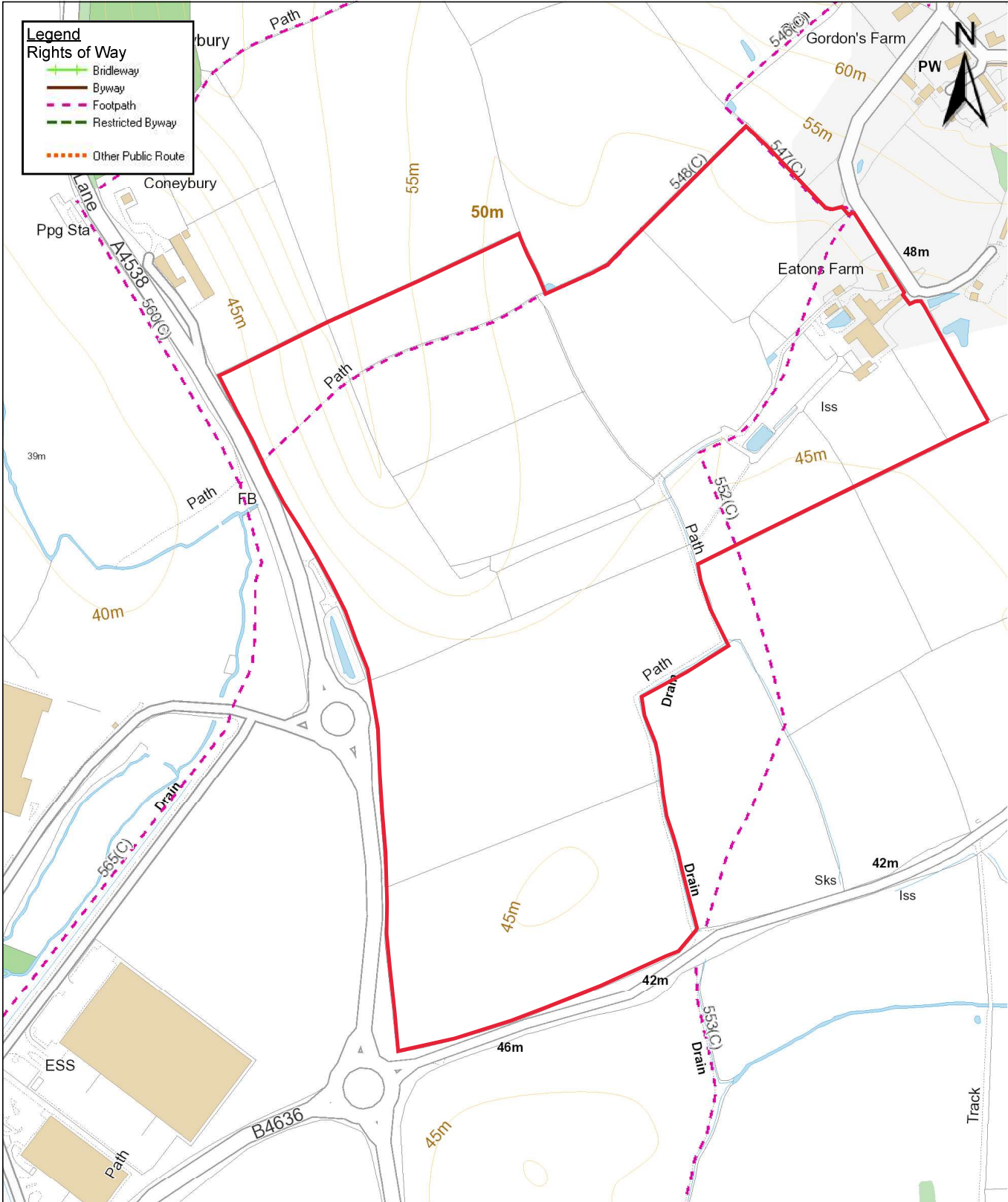

**Legend**  
**Rights of Way**

- Bridleway
- Byway
- Footpath
- Restricted Byway
- Other Public Route

© Crown copyright and database rights 2020  
 Ordnance Survey 100024230.

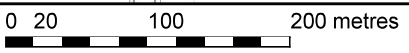

**WCC PLAN 4 - EATONS FARM AND ADJOINING LAND, CHURCH LANE, TIBBERTON, DROITWICH WR9 7NW**

Indicative Scale: 1:5,000

Date Printed: 7/5/2020



Worcestershire County Council  
 County Hall  
 Spetchley Road  
 Worcester  
 WR5 2NP



**Legend**

**Rights of Way**

- Bridleway
- Byway
- Footpath
- Restricted Byway
- Other Public Route

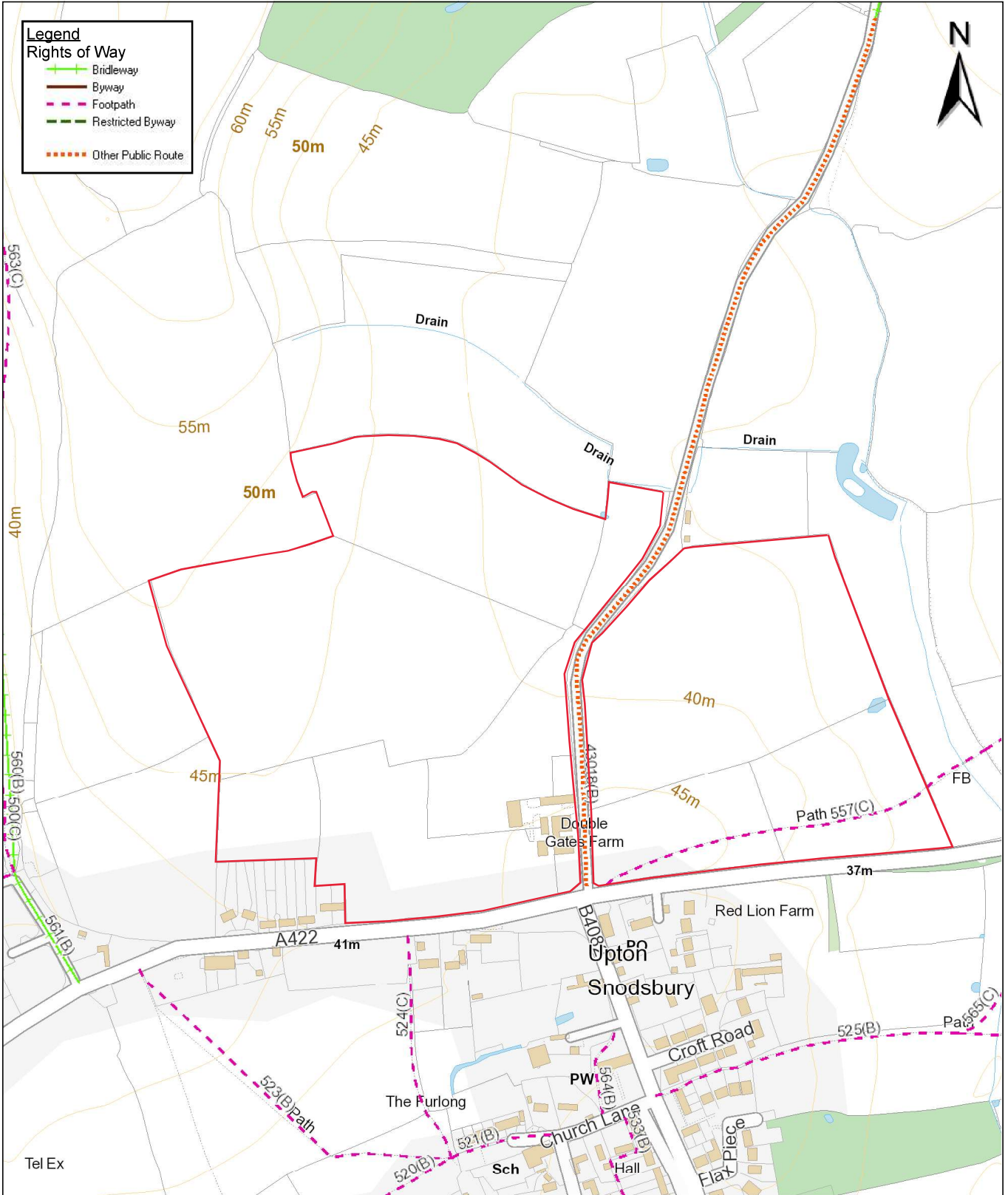

© Crown copyright and database rights 2020  
Ordnance Survey 100024230.

Indicative Scale: 1:5,000

Date Printed: 7/5/2020

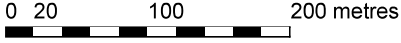

**WCC PLAN 5 - DOUBLE GATES FARM, PERSHORE ROAD, UPTON SNODSBURY, WORCESTER WR7 4NR**



Worcestershire County Council  
County Hall  
Spetchley Road  
Worcester  
WR5 2NP

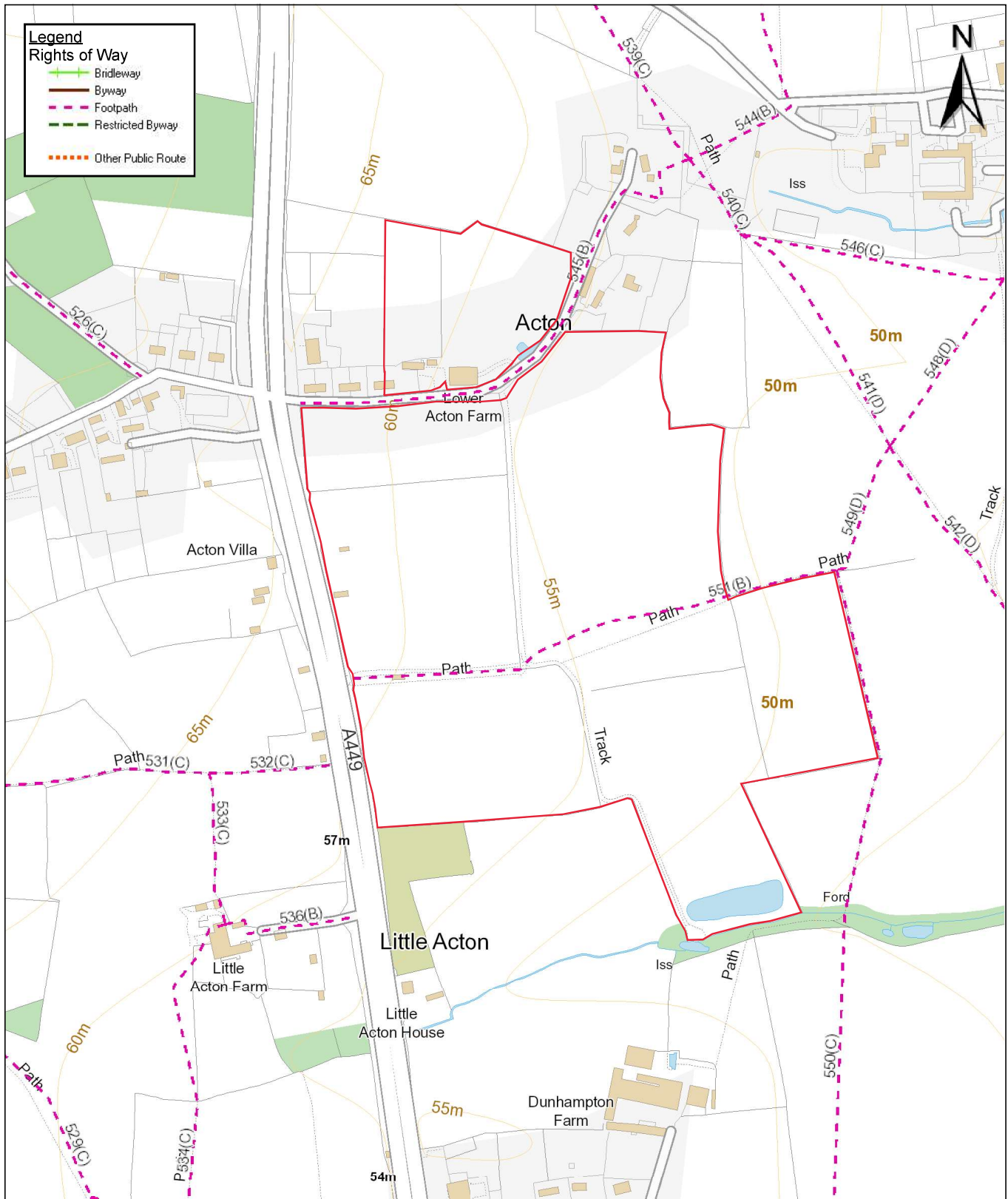

© Crown copyright and  
database rights 2020  
Ordnance Survey 100024230.

0 20 100 200 metres

WCC PLAN 6 - 12 ACTON COTTAGES AND  
ADJOINING LAND, ACTON, STOURPORT-ON-  
SEVERN DY13 9TE



Worcestershire County Council  
County Hall  
Spetchley Road  
Worcester  
WR5 2NP

Indicative Scale: 1:5,000

Date Printed: 26/5/2020