







PLAN FOLIO

WORCESTERSHIRE COUNTY COUNCIL
(HOOBROOK LINK ROAD, CLASSIFIED ROAD)
(SIDE ROADS) ORDER 2014

THESE PLANS DO NOT SHOW WIDTHS OR CONSTRUCTION DETAILS

SCALES:
KEY PLAN - 1:5000
SITE PLANS - 1:1250

KEY:

-  Highway boundary
-  Route of new classified road
-  Highway to be improved
-  New highway
-  Private means of access to be stopped up
-  New private means of access

THE COMMON SEAL of
WORCESTERSHIRE COUNTY COUNCIL

was hereunto affixed
this 15th day of May 2014
in the presence of :-

PRINCIPAL SOLICITOR



CH2M Hill, Inc.
304 Bridgewater Place, Birchwood Park,
Warrington, Cheshire. WA3 6XG.

Tel +44 (0)1925 867500
Fax +44 (0)1925 867600

worcestershire
highways

Drg. No.
473946-LA0010-SP-030

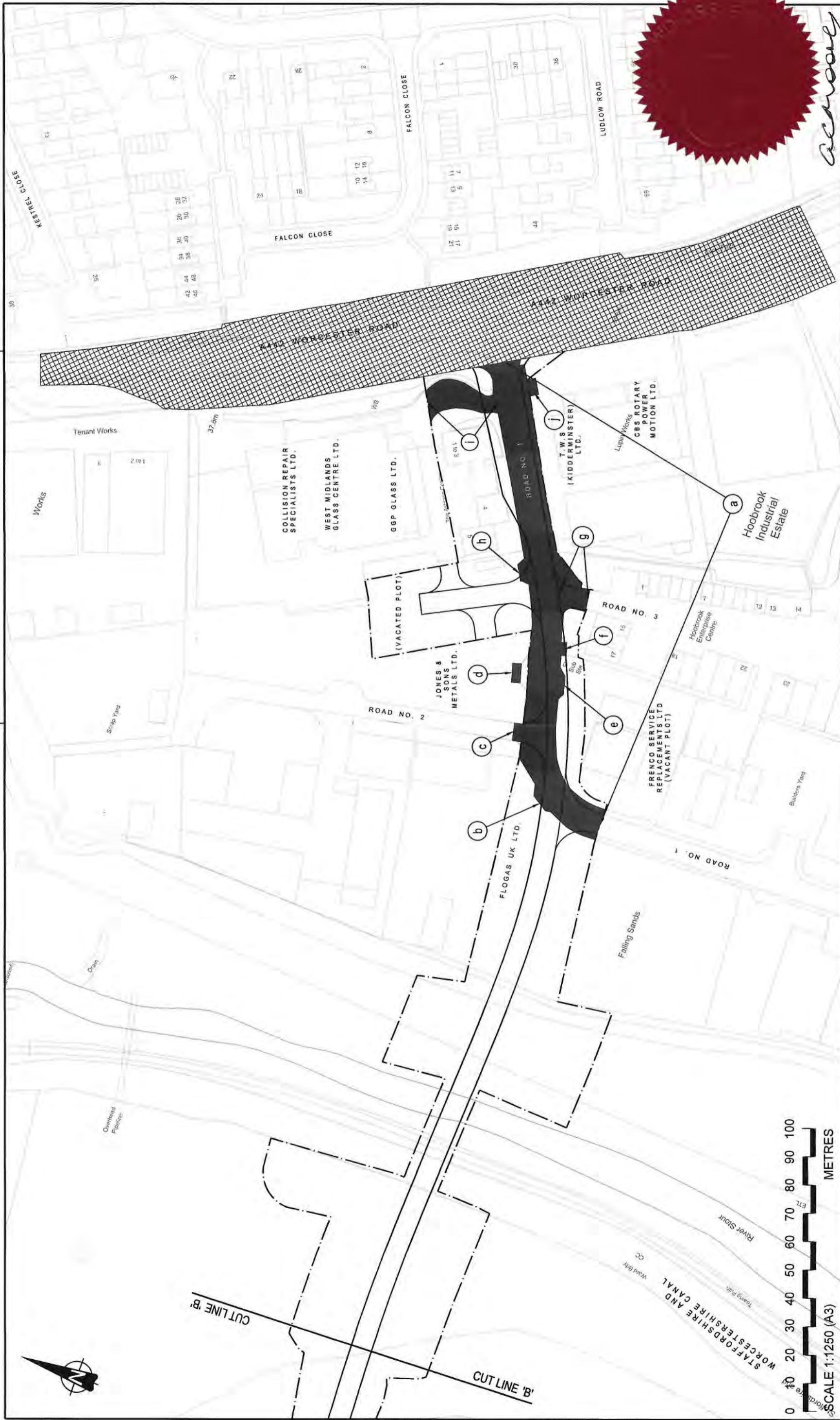

This plan is based upon Ordnance Survey material with the permission of Ordnance Survey on behalf of the controller of Her Majesty's Stationery Office © Crown copyright. Unauthorised reproduction infringes Crown copyright and may lead to prosecution or civil proceedings. Worcestershire County Council 100015914 2013.

- Key:**
- Highway boundary
 - Route of new classified road
 - Highway to be improved
 - Private means of access to be stopped up
 - New private means of access
 - New highway

worcestershire
highways
Drg.No. 473946-LA0010-SP-035

HOOBROOK LINK ROAD (PHASE 2)

WORCESTERSHIRE COUNTY COUNCIL (HOOBROOK LINK ROAD, CLASSIFIED ROAD) (SIDE ROADS) ORDER 2014
SITE PLAN 3 - INSET
A442 WORCESTER ROAD, ROAD NO.1, ROAD NO.2 AND ROAD NO.3

SCALE 1:1250(A3)

Survey	OS
Drawn	N.B
Checked	N.B
By	JC
Date	03.14

No.	Revision
-	FIRST DRAFT
A	OS BACKGROUND UPDATED
B	DRAWING ACCESS ARRANGEMENTS REVISED
C	PRIVATE ACCESSES REVISED
JC	03.14
IM	11.13
IM	10.13
By	Approved
By	JC
Date	03.14

CH2MHILL
CH2M Hill, Inc
304 Bridgewater Place, Birchwood Park,
Warrington, Cheshire, WA3 6XG.
Tel +44 (0)1925 867500
Fax +44 (0)1925 867600

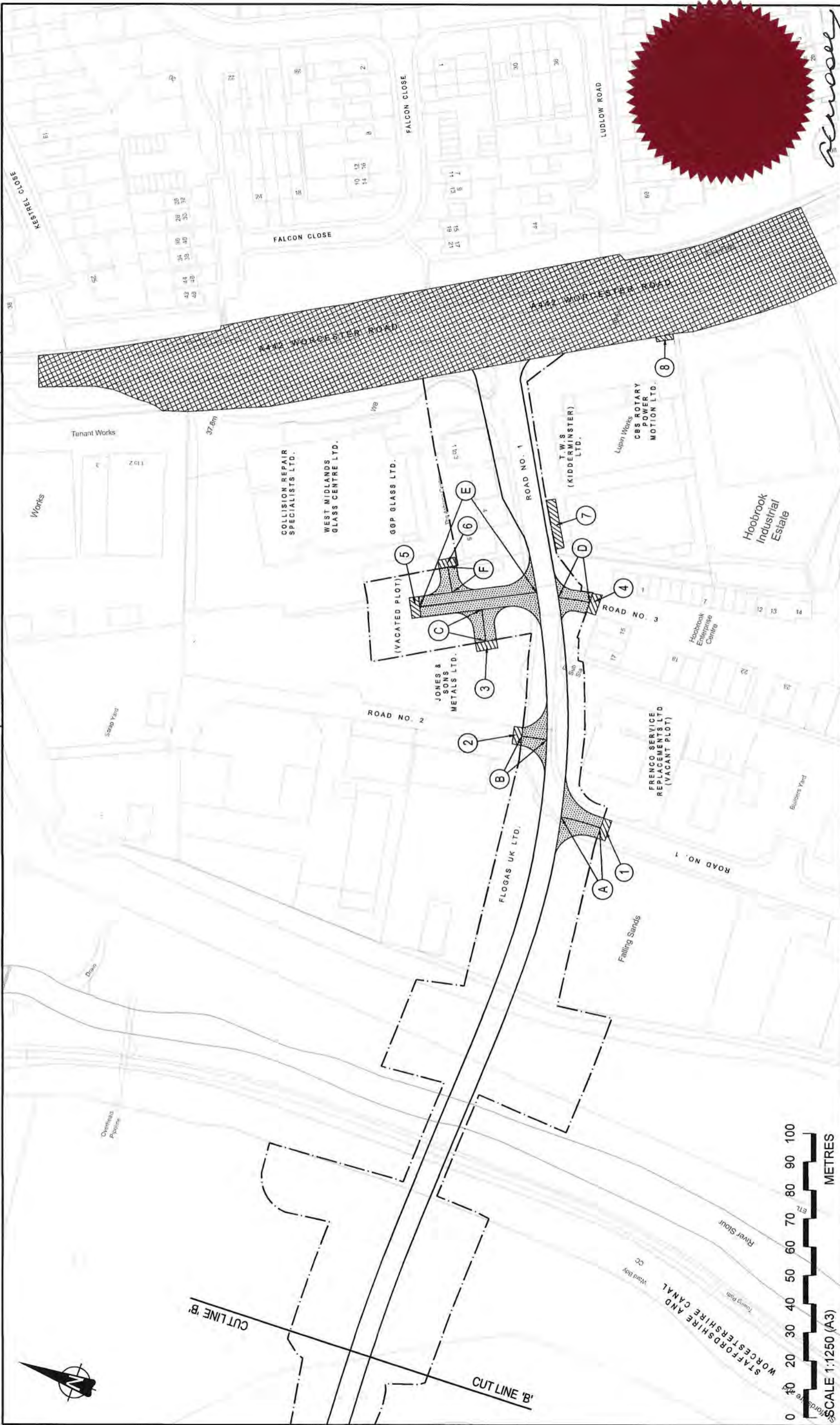

This plan is based upon Ordnance Survey material with the permission of Ordnance Survey on behalf of the controller of Her Majesty's Stationery Office © Crown copyright. Unauthorised reproduction infringes Crown copyright and may lead to prosecution or civil proceedings. Worcestershire County Council 100015914 2013.

Key:
 - - - Highway boundary
 - - - Route of new classified road
 [Cross-hatched] Highway to be improved
 [Diagonal lines] Private means of access to be stopped up
 [Dotted] New private means of access
 [Dashed] New highway

CH2MHILL
 CH2M Hill, Inc.
 304 Bridgewater Place, Birchwood Park,
 Warrington, Cheshire, WA3 6XG.
 Tel +44 (0)1925 867500
 Fax +44 (0)1925 867600

No.	Revision	By	Date	Approved	By	Date
C	FINAL ISSUE	JC	03.14	Survey	OS	
B	PRIVATE ACCESSES REVISED	JC	02.14	Drawn	NMB	03.14
A	ROAD ACCESS ARRANGEMENTS REVISED	IM	11.13	Checked	NMB	03.14
-	OS BACKGROUND UPDATED	IM	10.13	By	JC	03.14
-	FIRST DRAFT					

SCALE 1:1250(A3)

Worcestershire County Council (Hoobrook Link Road, Classified Road) (Side Roads) Order 2014
 SITE PLAN 3
 A442 WORCESTER ROAD, ROAD NO.1, ROAD NO.2 AND ROAD NO.3

worcestershire highways
 Drg.No. 473946-LA0010-SP-034

HOOBROOK LINK ROAD (PHASE 2)