



**DEFINITIVE MAP MODIFICATION ORDER APPLICATION
PRIORITISATION***

Application	File Ref	M318
Addition of Footpath from Stourbridge Road via Podmore Pool to Murcott Lane		
Applicant		
Cllr. K Stokes on behalf of the Friends of Broadwaters 157 Sion Avenue, Kidderminster		
Date Submitted	11.1.2008	

Application Prioritisation Criteria*	Score
Conflict Resolution	3
Development	1
Effective use of Resources	3
Level of Support	3
The Wider Public Rights of Way Network and ROWIP Objectives	3
Total	13

(*Refer DMMO Application Prioritisation Standard Operational Procedure)

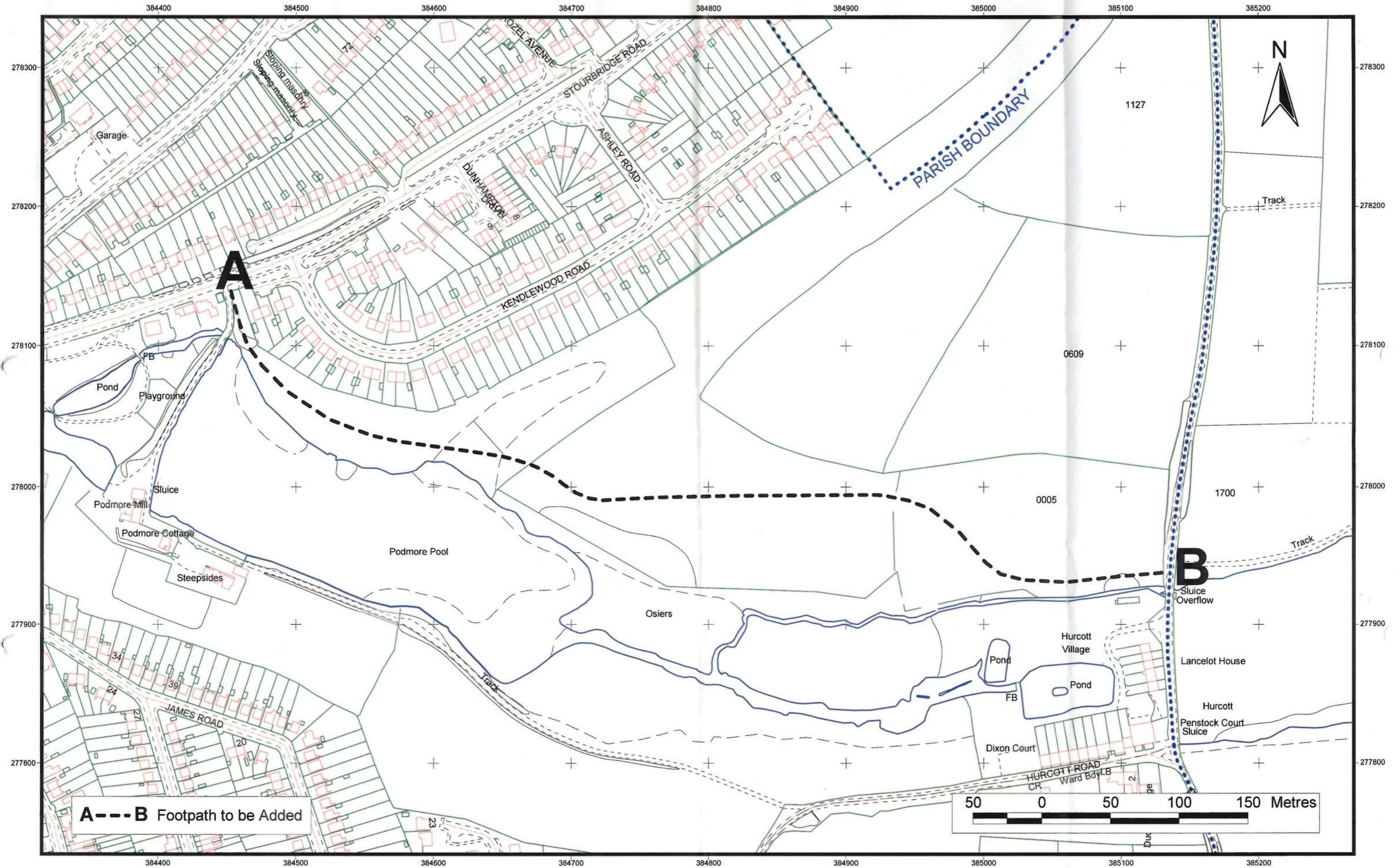

A---B Footpath to be Added

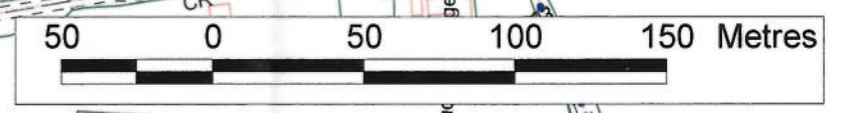

DEFINITIVE MAP MODIFICATION ORDER TO ADD A FOOTPATH IN THE PARISH OF KIDDERMINSTER DISTRICT OF WYRE FOREST

SCALE: 1:2500

© Crown copyright. All rights reserved.
 Worcestershire County Council 100015914
 For reference purposes only.
 No further copies may be made.



NOTICE OF APPLICATION FOR MODIFICATION ORDER
WILDLIFE AND COUNTRYSIDE ACT 1981

TO: COUNTRYSIDE MAPPING MANAGER, ENVIRONMENTAL SERVICES
OF: COUNTY HALL, SPETCHLEY ROAD, WORCESTER, WR5 2NP

I/We COUNCILLOR K STOKES ON BEHALF OF FRIENDS OF BROADWATERS, RESIDENTS
OF BROADWATERS AND THE SEVERN SIDE RAMBLER
of 157 SION AVENUE, KIDDERMINSTER, DY10 2YL

hereby apply for an order under Section 53(2) of the Wildlife and Countryside Act 1981
modifying the definitive map and statement for the area by

i. Deleting the scheduled (footpath) (bridleway) (byway open to all traffic) No.

From

To

ii. (Upgrading) (downgrading) to a (footpath) (bridleway) (byway open to all traffic) the
scheduled (footpath) (bridleway) (byway open to all traffic) No.

From HURCOTT VILLAGE

To STOURBRIDGE RD (PUBLIC RIGHT OF WAY)

iii. (Varying) (adding to) the statement relating to the (footpath) (bridleway) (byway open
to all traffic) No.

From HURCOTT VILLAGE

To STOURBRIDGE RD KIDDERMINSTER

By providing that PUBLIC RIGHT OF WAY

iv. Adding the (footpath) (bridleway) (byway open to all traffic)

From HURCOTT VILLAGE

To STOURBRIDGE RD KIDDERMINSTER

And shown on map annexed hereto.

I/We attach copies of the following documentary evidence (including statements of
witnesses) in support of this application.

8 MOI
1 LETTER
1 MAP

ALSO A COVERING
LETTER

Dated 10 - 1 - 2008 Signed

i. ii. iii. iv. Delete as appropriate



CERTIFICATE OF SERVICE OF NOTICE OF
APPLICATION FOR MODIFICATION ORDER
WILDLIFE AND COUNTRYSIDE ACT 1981

TO: COUNTRYSIDE MAPPING MANAGER, ENVIRONMENTAL SERVICES,
WORCESTERSHIRE COUNTY COUNCIL
OF: COUNTY HALL, SPETCHLEY ROAD, WORCESTER, WR5 2NP

I/we call K J STOKES REPRESENTING FRIENDS OF BROADWATERS
RESIDENTS OF BROADWATERS AND SEVERNSIDE RAMBLERS
of 157, SION AVENUE, KIDDERMINSTER, DY10 2YL

hereby certify that the requirements of paragraph 2 of Schedule 14 of the Wildlife and
Countryside Act 1981 have been complied with, and notice has been duly served on the
following Occupiers:

Name

Address

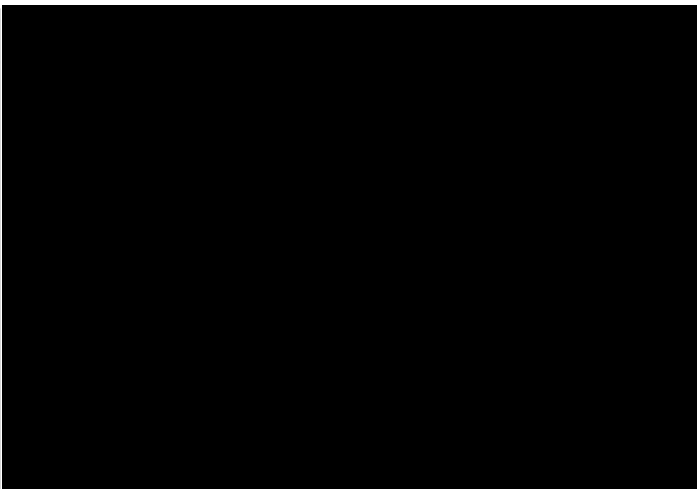

MORE MILL POPMORE FARM
BROADWATERS KIDDERMINSTER
WORCESTERSHIRE DY10 2XL
COLLAGE ST
WORCESTER
WR1 2LU

Dated 10 - 1 - 2008 Signed

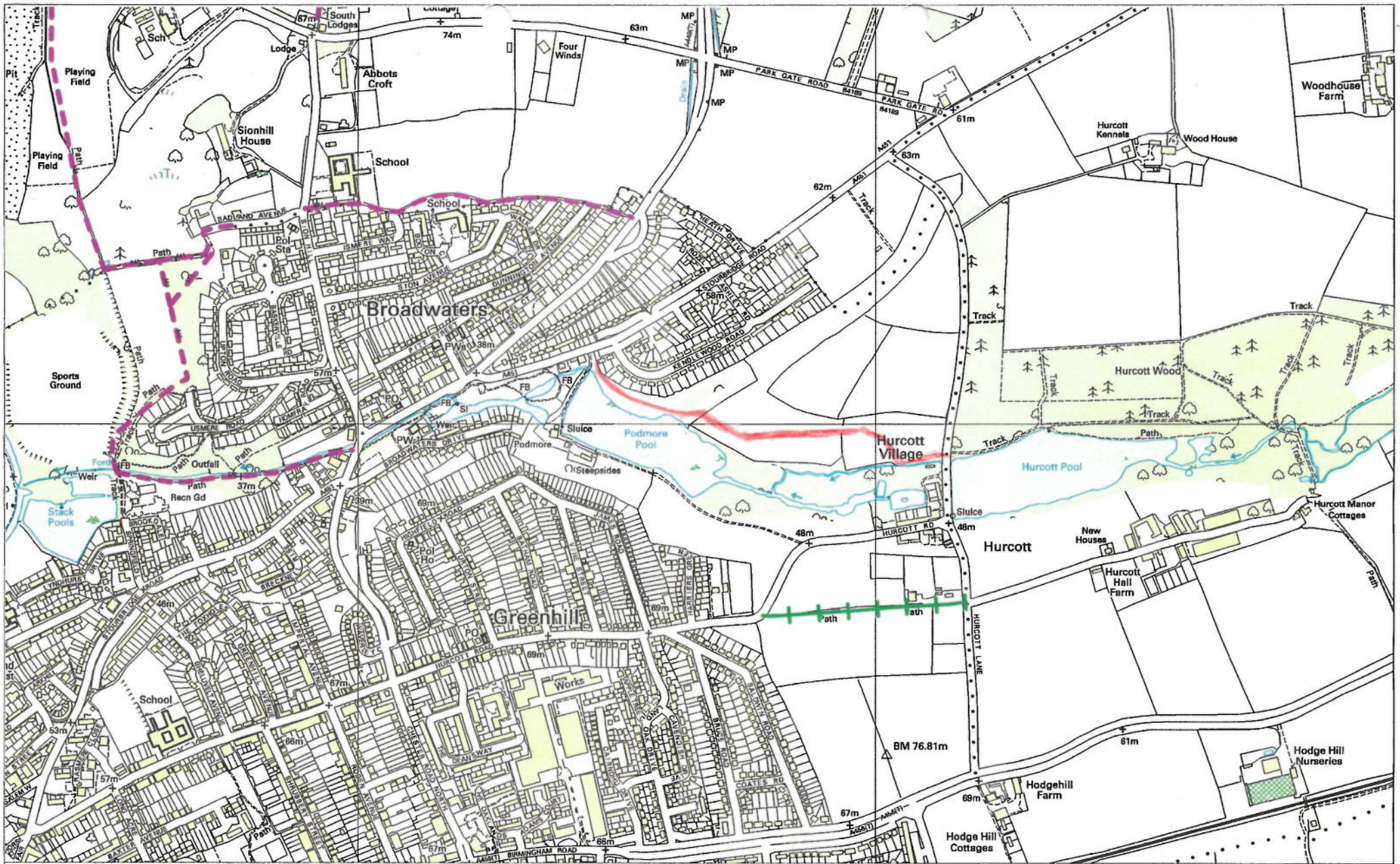

worcestershire
county council

Countryside Service,
County Hall,
Spetchley Road,
Worcester WR5 2NP

100 0 100 200 300 400 Meters

Scale 1:10000

For illustrative purposes. Please note that only the Definitive Map & Statement held by WCC contains information that is legally conclusive about Public Rights of Way.

- Bridleway
- Byway
- Footpath



© Crown copyright. All rights reserved.
Worcestershire County Council 100015914
For reference purposes only
No further copies may be made.