



**DEFINITIVE MAP MODIFICATION ORDER APPLICATION
PRIORITISATION**

Application	Upgrading Byway Open to All Traffic that part of bridleway CQ-504 (formerly No.4) from Haywayn to just past the entrance to Cropthorne Fruits
File Ref	M-312 (M-631)
Applicant	Mr C Tunstill, Summer Place, Blacksmiths Lane, Cropthorne, Pershore, Worcs WR10 3LX
Date Submitted	27 April 2006

Application Prioritisation Criteria	Score
Conflict Resolution	1
Development	1
Effective use of Resources	1
Level of Support	1
The Wider Public Rights of Way Network and ROWIP Objectives	1
Total	5

Details of how these have been prioritized can be found in the DMMO Application Prioritisation Standard Operational Procedure

Summary of Information provided for Definitive Map Modification Order

The information below provides a summary for accessibility purposes of the scanned original application form documents attached.

Application Reference. M-312 (M-631)

Applicant Name

Christopher John Tunstill

Applicant Address

Summer Place
Blacksmiths Lane
Crothorne
Worcester WR10 3LX

The above hereby apply for an order under section 53(2) of the Wildlife and Countryside Act 1981 modifying the definitive map and statement for the area by:

Upgrading to a byway open to all traffic the scheduled bridleway CQ 504 (formerly number 4) from its western end (outside Heywayn) in Blacksmiths Lane to just past the entrance to Crothorne Fruits in Blacksmiths Lane

And shown on the map accompanying this application.

Dated and signed

26 April 2006

Confirmation was also submitted that Notice was served by the applicant on the following landowners of this application being made.

Rustic Cottage, Blacksmiths Lane, Crothorne WR10 3LX
Lyde, Blacksmiths Lane, Crothorne, WR10 3LX
Drumearn, Blacksmiths Lane, Crothorne WR10 3LX
Heywayn, Blacksmiths Lane, Crothorne WR10 3LX
2 Manor Court, Crothorne WR10 3PX
(Crothorne Fruits), Old Hall, Main Street, Crothorne, WR10 3NB
(Corehill Farm), Holmfield, Eckington WR10 3DE

Scanned application documents

M.O.1

NOTICE OF APPLICATION FOR MODIFICATION ORDER
WILDLIFE AND COUNTRYSIDE ACT 1981

TO: COUNTRYSIDE MAPPING MANAGER, ENVIRONMENTAL SERVICES
OF: WOODSIDE OFFICES, PERRY WOOD WALK, WORCESTER, WR5 1ES

IN the presence of CHRISTOPHER JOHN TUNSTILL
of "SUMMER PLACE", BLUESMITHS LANE, CROPTHORNE, WR10 3LX

hereby apply for an order under Section 53(2) of the Wildlife and Countryside Act 1981
modifying the definitive map and statement for the area by

i. Deleting the scheduled (~~footpath~~) (bridleway) (byway open to all traffic) No.

From.....

To.....

ii. (Upgrading) (~~downgrading~~) to a (footpath) (bridleway) (byway open to all traffic) the
scheduled (~~footpath~~) (bridleway) (~~byway open to all traffic~~) No.

From ITS WESTERN END (OUTSIDE "HEWAGN") in BLUESMITHS L.

To JUST PAST THE ENTRANCE TO "CROPTHORNE FRUITS" in

HIGHLIGHTED BLUE BLUESMITHS L.A.

iii. (Varying) (adding to) the statement relating to the (footpath) (bridleway) (byway open
to all traffic) No.

From.....

To.....

By providing that.....

iv. Adding the (footpath) (bridleway) (byway open to all traffic)

From.....

To.....

And shown on map annexed hereto.

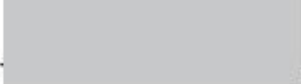

I/we attach copies of the following documentary evidence (including statements of
witnesses) in support of this application.

Dated 26th April 2006 Signed 

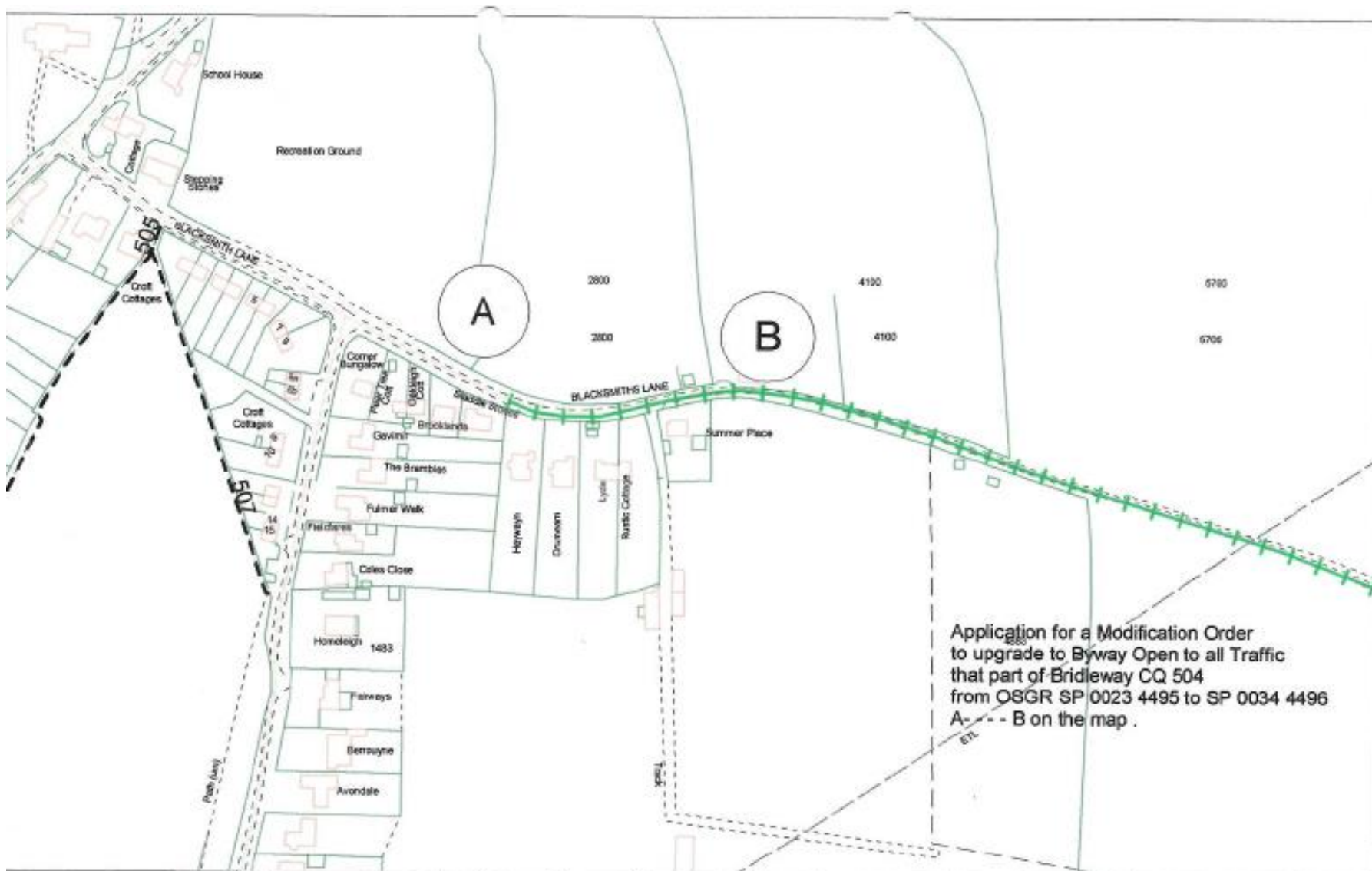
i. ii. iii. iv. Delete as appropriate



Application for a Modification Order to upgrade to Byway Open to all Traffic that part of Bridleway CQ 504 from OSGR SP 0023 4495 to SP 0034 4496 A - - - B on the map .

 worcestershire county council	Countryside Service, Woodside, Perrywood Walk, Worcester WR5 1ES	40 0 40 80 Meters Scale 1:2500	Bridleway Byway Footpath	 © Crown copyright. All rights reserved. Worcestershire County Council 100015916 For reference purposes only. No further copies may be made.
	Extract from Definitive Map for Worcestershire Relevant Date: 31st March 2005			
	Map of Bridleway Crophorne No.504 (formerly No.4)			