



## DEFINITIVE MAP MODIFICATION ORDER APPLICATION PRIORITISATION

<b>Application</b>	Addition of footpath from U46609 Pool Close to a junction with footpath number 501 (formerly 34)
<b>File Ref</b>	<b>M246</b>
<b>Applicant</b>	Little Comberton Parish Council c/o the Parish Clerk
<b>Date Submitted</b>	30 Januray 2004

<b>Application Prioritisation Criteria</b>	<b>Score</b>
Conflict Resolution	2
Development	1
Effective use of Resources	1
Level of Support	2
The Wider Public Rights of Way Network and ROWIP Objectives	2
<b>Total</b>	<b>8</b>

Details of how these have been prioritized can be found in the DMMO Application Prioritisation Standard Operational Procedure

## Summary of Information provided for Definitive Map Modification Order

The information below provides a summary for accessibility purposes of the scanned original application form documents attached.

### Application Reference. M246

#### Applicant Name

Little Comberton Parish Council

#### Applicant Address

c/o Midawy Cottage, Pershore Road, Little Comberton WR10 3HF

The above hereby apply for an order under section 53(2) of the Wildlife and Countryside Act 1981 modifying the definitive map and statement for the area by:

Adding the footpath / bridleway / byway open to all traffic from Pool Close, Little Comberton to footpath running adjacent to field

And shown on the map accompanying this application.

#### Dated and signed

5 October 2004

Confirmation was also submitted that Notice was served by the applicant on the following landowners of this application being made.

8 Pool Close, Little Comberton WR10 3EL  
5 Pool Close Little Comberton WR10 3EL

Scanned application documents



NOTICE OF APPLICATION FOR MODIFICATION ORDER  
WILDLIFE AND COUNTRYSIDE ACT 1981

TO: COUNTRYSIDE MAPPING MANAGER, ENVIRONMENTAL SERVICES  
OF: PO BOX 373, SPETCHLEY ROAD, WORCESTER. WR5 2XG

We LITTLE COMBERTON PARISH COUNCIL

of 90 MIDWAY COTTAGE, PEASWICK CO. LITTLE COMBERTON WR10 3HF

hereby apply for an order under Section 53(2) of the Wildlife and Countryside Act 1981 modifying the definitive map and statement for the area by

i. Deleting the scheduled (footpath) (bridleway) (byway open to all traffic) No.  
From.....  
To.....

ii. (Upgrading) (downgrading) to a (footpath) (bridleway) (byway open to all traffic) the scheduled (footpath) (bridleway) (byway open to all traffic) No.  
From.....  
To.....

iii. (Varying) (adding to) the statement relating to the (footpath) (bridleway) (byway open to all traffic) No.  
From.....  
To.....  
By providing that.....

iv. Adding the (footpath) (bridleway) (byway open to all traffic)  
From POOL CLOSE, LITTLE COMBERTON  
To FIELD FOOTPATH RUNNING ADJ. TO FIELD

And shown on map annexed hereto.

We attach copies of the following documentary evidence (including statements of witnesses) in support of this application.

Dated 5-10-04 ~~30-11-04~~ 20..... Signed.....  
i. ii. iii. iv. Delete as appropriate

EVIDENCE: DEVELOPMENT PLAN.  
OS. MAPS  
TITLE DEED 7. USED EVIDENCE FORMS

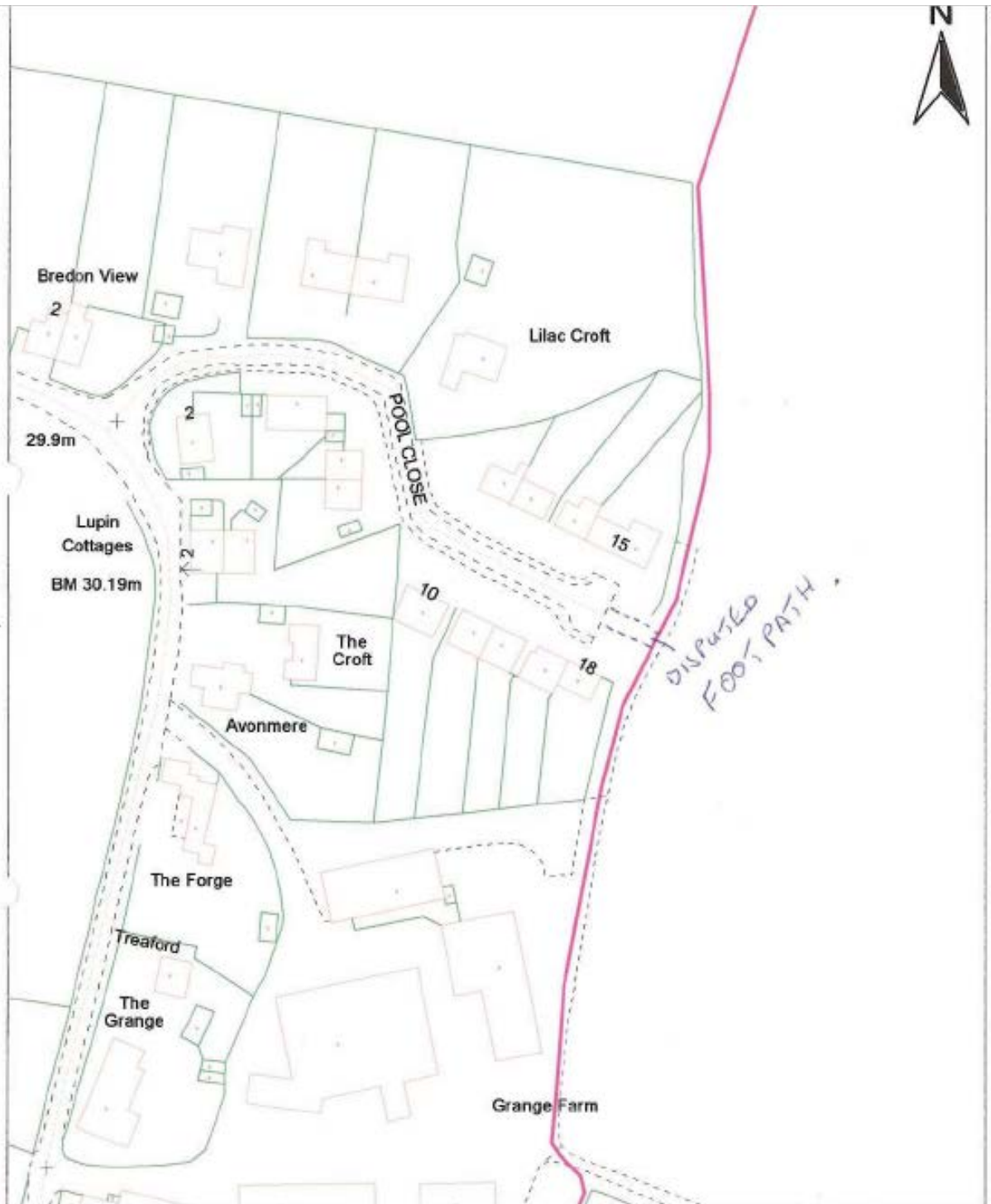

**worcestershire**  
 county council  
 Countryside Service,  
 Woodside,  
 Perrywood Walk  
 Worcester WR5 1ES

Scale: 1:1,250

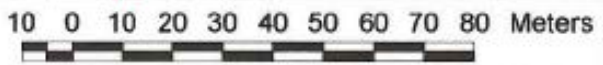

**NOT DEFINITIVE**

© Crown copyright. All rights reserved.  
 Worcestershire County Council 100015914  
 For reference purposes only.  
 No further copies may be made.